



Regional Office  
Bhinga

Tender Ref. no. ROBHN/A&S/2024-25/ 128

Date:-03.08.2024

TENDER NOTICE

**FURNISHING WORKS FOR ARYAVART BANK AT REGIONAL OFFICE BHINGA AT VILLAGE/ MOHALLA-PURE KHAIRE,PARGANA-BHINGA,DISTT-SHRAVASTI (U.P)**

The bank invites tender from bank's empanelled contractors under interior furnishing contractors category for the above mentioned work for which schedule of quantities, general conditions, special conditions/additional conditions are available at bank's website <http://www.aryavart-rrb.com> and the same is available at Bank's Regional Office at Aryavart Bank First Floor Hospital Chauraha Civil Lines Bahraich-271801

Sealed tenders accompanied by a Bank Draft for Rs. 25000.00 (Twenty five thousand) in favour of Aryavart Bank, payable at **Bhinga Shrawasti (U.P)** as earnest money should reach Bank's **Aryavart Bank Regional Office at First Floor Hospital Chauraha Civil Lines Bahraich-271801** on or before 5:00 P.M. on date 23.08.2024 in sealed cover. The tenders shall be opened on the same day at 5.30 P.M. The tenders received late on account of any reason whatsoever shall not be entertained. The tender shall be valid for a period of not less than 90 days of opening of tender.



Time of Completion 21 days.

(From date of award of work)

Aryavart Bank, shall not be bound to accept the lowest tender & reserves the right to accept or reject any or all the tenders without assigning any reason whatsoever.

Yours faithfully,

Amit Varshney  
(Regional Manager)



INDEX

S. NO.	PARTICULARS
1.	TENDER NOTICE.
2.	LETTER SUBMITTING TENDER.
3.	SPECIMEN COPY OF AGREEMENT.
4.	GENERAL CONDITIONS.
5.	TECHNICAL SPECIFICATIONS FOR FURNISHING & MINOR CIVIL WOKS.
6.	DETAILED SPECIFICATIONS FOR FURNISHING & MINOR CIVIL WORKS.
7.	APPROVED MAKES FOR FURNISHING & MINOR CIVIL WORKS.
8.	SCHEDULE OF TENDER DRAWINGS.
9.	BILL OF QUANTITIES.



*[Handwritten signature]*

LETTER SUBMITTING TENDER

To,

-----  
-----  
-----

Dear Sir,

With reference to the tender invited by you for the work \_\_\_\_\_

I/We do hereby offer to execute the work under contract at the respective rates mentioned in the Schedule of quantities. I/We have seen the site, understood the general conditions of contract, schedule of quantities etc.

I/We agree to execute the work as per specification, general conditions of contract, special conditions, additional conditions, schedule of quantities etc.

I/ We have deposited Earnest Money Rs. 25000 by demand draft which amount is not to bear any interest. I/We do hereby agree that this sum shall be forfeited by you in the event our tender is accepted and I/We fail to execute the contract when called upon to do so.

I/We understand that you are not bound to accept the lowest or any tender that you receive.

Yours faithfully,

(SEAL & SIGNATURE OF CONTRACTOR)

- 1) Name of partner (s) of the firm
- 2) Name of our banker
- 3) Demand Draft No. ...., Dated.....

Tender submitted on ..... before ..... P. M.



*[Handwritten signature]*



**SPECIMEN COPY OF AGREEMENT**

(Subject to change in order to availability from Regional Office)

**For works exceeding Rs. 1.00 Lac agreement should be drawn on Stamp Paper.**

**ARTICLES OF AGREEMENT :**

Agreement made at..... this..... day of..... between  
Aryavart Bank, Regional Office, Bhinga (U.P.)  
herein referred to as Aryavart Bank, Regional Office, Bhinga, Shrawasti (U.P.) which expression shall include its  
heirs, executors administrators and assigns the one part and

.....  
herein referred to as the successful tenderer/contractor which expression shall include his heirs, executors,  
administrators and assigns of the other part. Whereas Aryavart Bank, Regional Office Bhinga, (U.P.) is desirous of  
carrying out of the work..... and has caused specifications  
etc. describing the work to be done as per schedule of quantities, along with the general conditions of contract,  
special conditions, additional conditions etc. and whereas the contractor has agreed to execute the work described  
in said priced schedule of quantities, general conditions of contract special condition, additional conditions at the  
respective rates mentioned in the priced schedule of quantities attached.

Whereas the contractor has deposited Rs. .... with the Aryavart Bank, Regional Bhinga, First Floor  
Hospital Chauraha ,Civil Lines ,Bahraich-271801 (U.P.) as earnest money for due performance of the agreement.

**NOW IT IS HEREBY AGREED AS FOLLOWS:**

1. In consideration of the payment to be made to the contractor as herein provided he shall upon and  
subject to the said conditions execute and complete the work as per the said conditions and priced  
schedule of quantities.
2. The Aryavart Bank, Regional Office, Bhinga, (U.P.) shall pay the contractor such sums as shall become  
payable hereunder at the times and in manner specified in the conditions.
3. The said conditions shall be read and form part of the agreement and the parties hereto shall respectively  
abide by and submit themselves to the conditions and stipulations and perform the agreement on their  
parts respectively on such conditions contained.
4. All disputes arising out of in any way connected with this agreement shall be deemed to have arisen in  
only the Court/Arbitrator in Shrawasti shall have jurisdiction determine the same.
5. The several parts of this contract have read to us and fully understood by us.

WITNESS)

(Aryavart Bank, Regional Office, Bhinga, Shrawasti)

(CONTRACTOR)





GENERAL CONDITIONS

1. Sealed tenders should be addressed to Regional Manager, Aryavart Bank, Regional Office, Bhinga Add-Hospital Chauraha, First Floor, Civil Line Bahraich, Pin-271801 (U.P.) and super scribed NAME OF WORK- FURNISHING WORKS FOR Aryavart BANK at Regional Office Bhinga and should reach the office before 5:00 PM. on 05.08.2024.
2. No tenders shall be received after 5.00 PM. on 23.08.2024 and the tenders shall be opened on the same day at 5.30 P.M. (subject to availability of tender committee members)
3. Any clarification (in writing) whatsoever shall be sought from the Architect, minimum two days before the tender submission date.
4. The tenders shall remain valid for a period of 3 months from the date of opening of tenders, Aryavart Bank, Regional Office, Bhinga Add-Hospital Chauraha, First Floor, Civil Line Bahraich, Pin-271801 (U.P.) reserves the right to accept or reject any or all the tenders without assigning any reason to do so.
5. At the time of submission, every tender must be accompanied by a Demand Draft of Rs. 25000.00 in favour of Aryavart Bank Payable at Bhinga Shrivasthi (U.P.) as earnest money. No interest shall be paid on earnest money. Any tender which is not accompanied by the earnest money shall be summarily rejected.
6. The tenders should quote the rates in figures as well as in words in Indian currency only.
7. All erasures and alterations made while filling the tender must be attested by initials of tenderer. Overwriting of the figures in not permitted.
8. The earnest money deposit of unsuccessful tenderers shall be returned after the tender is decided or on expiry of validity period.
9. The earnest money of the successful tender shall be adjusted in the initial security deposit.
10. Aryavart Bank, Regional Office, Bhinga Add-Hospital Chauraha, First Floor, Civil Line Bahraich, Pin-271801 (U.P.) reserves the right to reject any or all the tenders, accept part of any tender or entrust the entire work to any contractor or divide the work to more than one contractor (item wise) without assigning any mason or giving any explanation. The rates quoted by the contractor shall hold good for this bifurcation and no compensation shall be paid on this account.
11. Joint tenders shall not be considered.
12. On receipt of intimation from the Aryavart Bank, Regional Office, Bhinga Add-Hospital Chauraha, First Floor, Civil Line Bahraich, Pin-271801 (U.P.) of the acceptance of his tender, the tenderer within 7-days should submit this acceptance of the work order. If the successful tenderer to undertake the work, the earnest money deposited by him shall be forfeited and acceptance of his tender maybe withdrawn.
13. The rates quoted in the tender shall include all charges of materials, shifting of furniture, scaffolding/ladder, lift up and down, mechanical transportation, loading, unloading, any or special tools and plants, railway freight, labour, taxes etc. It shall also take care for all conditions and fluctuation in the material and labour rates, excise duty, sales tax, trade tax, service tax, cartage, octroi and any other taxes or expenditure for carrying out the work.  
The rates quoted in the tender shall also include for the charges for carrying out various types of laboratory/site tests for different types of materials.



*[Handwritten signature]*



14. The contractor shall arrange water and electricity for completing the work.
15. No escalation in rates shall be allowed under any circumstances.
16. The successful tenderer is bound to carry out entire work within the period stipulated in the Appendix. The tenderer shall have to pay liquidated damages for non-completion of job within stipulated period at the rate of 1% of the contract value for every week of delay maximum up to 2 weeks, thereafter. In case, the delay persists more than two weeks, the bank reserves its right to cancel the work order at its discretion.
17. The liquidated damages as mentioned above may not be enforced if the contractor applies for extension of time mentioning the reasons for extension. Extension of time in days shall be granted by the **Aryavart Bank, Regional Office, Bhinga (U.P.)** if it is proved that contractor is not at fault for extending the work beyond stipulated date of completion.
18. The successful tenderer is bound to carry out items of work necessary for completion of job even though the same are not included in the schedule of quantity. Rates of extra items shall be derived from the tender. In case the rates do not exist in the tender and extra item is not similar to tender item, then the rates shall be worked out on the prevailing market cost of material and labour, including wastage plus 15% towards tax and Contractor's profit.
19. The Contractor must co-operate with other contractors appointed by the **Aryavart Bank, Regional Office, Bhinga (U.P.)** so that entire work shall proceed smoothly with least possible delay and to the satisfaction of the Aryavart Bank, Regional Office, Bhinga.
20. The Contractor shall remove all debris, unused material etc. wash and clean the floors regularly at his own cost and hand over the site in proper manner on the completion of work.
21. The tenderer is advised to visit the site and acquaint himself with the site conditions, making his own arrangement for storing of material at site, lift, cartage, etc.
22. The initial security deposit shall be made, @ 2% of the accepted contract value less (subtracting) earnest money deposit, by the successful tenderer within 14 days of acceptance of his tender. It shall be submitted in form of Bank Draft in favor of Regional Manager, Aryavart Bank, Regional Office, Bhinga.
23. The successful tenderer shall have to enter in to an agreement with the Bank
24. 8% of the value of work done shall be deducted as retention money from the interim payments made to the contractor, and shall be retained for defects liability period (as mentioned in the Appendix) and shall be released after the defects liability period, provided no defects are noticed during the period. This retention money along with earnest money deposit and initial security deposit would make the security deposit to be deposited by the contractor.
25. The contractor shall attend to all defects noticed during defects liability period. If the contractor fails to attend the defects, these defects shall be rectified by the Aryavart Bank, Regional Office, Bhinga and the expenditure incurred on this account shall be recovered from security deposit.
26. The contractor shall make adequate arrangement for watch and ward of his material and shall ensure the safety, breakage and any theft of materials fixed or unfixed by him or other sub contractors.



*[Handwritten signature]*



27. The work executed should be got approved by Aryavart Bank, Regional Office, Bhinga and contractor shall rectify any bad workmanship pointed out at any stage and remove from site all the rejected materials immediately.
28. The contractor shall be responsible for application of labour laws, compensation for injury and accident to person, whether employed by him or by his sub-contractor.
29. The contractor shall take necessary precautions for carrying out the work avoiding any damage to structures/decorative parts of the property. The contractor shall rectify any damages done at his cost.
30. Furnishing, Civil, Water Supply & Sanitary, Electrical and Demolition works shall be carried out as per drawings/specifications and to the entire satisfaction of the Aryavart Bank, Regional Office, Bhinga.
31. The contractor shall give due notice to the Aryavart Bank, Regional Office, Bhinga to check measurements of any work which is likely to be hidden before covering the same.
32. The contractor shall submit running bills for the value of work done not less than interim payment (as mentioned in the Appendix) mentioning full nomenclatures of items, rates, amount, measurements sheets, reasons for part rates claimed, if any.
33. In case of non-completion or delay in completion of work or removal of defects in time, the Aryavart Bank Regional Office, Bhinga shall be free to appoint another agency to get the job done at contractor's risk and cost
34. For fixed as well as loose furniture, rates quoted by the contractor shall be inclusive of all taxes, including sales tax, trade tax, octroi, transportation etc and no extra amount shall be paid on this account.
35. Income-tax at the rate of 2.0% (or as applicable from time to time) of the bill amount shall be deducted at source from the contractor's bill and shall be deposited with the I.T.O. as per rules.
36. Aryavart Bank, Regional Office, Bhinga may delay the progress of work without, in any way, vitiating the contract and grant such extension of time for the commencement/completion of the contract as it may think proper and sufficient in consequence of such delay and the contractor shall not make claim for compensation or damage in relation thereof.
37. The contractor shall not execute any extra item without Aryavart Bank, Regional Office, Bhinga permission in writing.
38. The quantities mentioned in the schedule of quantities are approximate. Payment shall be made on actual work done by the contractor. However, the contractor should not deviate the quantity without Aryavart Bank, Regional Office, Bhinga permission.
39. Conditional tenders quoted by the tenderer are liable to be rejected.
40. Aryavart Bank, Regional Office, Bhinga has a right to alter the nature of work and to add or omit any items of work or to have the option of the same carried out departmentally or otherwise and such alterations or variations shall be carried out without prejudice to this contract
41. In case the particular make of material mentioned not available at the time of execution of the work, the alternative make of materials shall be got approved from the Aryavart Bank, Regional Office, Bhinga (U.P.)/ Architect before its use.





42. Arvavart Bank, Regional Office, Bhinga has right to terminate the contract, if the contractor abandons the work, or fails to commence and complete the work in time, or fails to abide by the contract conditions.
43. Arbitration - In case of any dispute between **Arvavart Bank, Regional Office, Bhinga & contractor**, the decision taken by the arbitrator who shall be appointed by the Arvavart Bank, Regional Office, Bhinga shall be final.
44. The contractor shall have to **BUY BACK** the dismantled items. The particulars, quantity etc. of the said items shall be provided by the Arvavart Bank, Regional Office, Bhinga at a later date.

(ARVAVART BANK, REGIONAL OFFICE BHINGA (UP.))

(CONTRACTOR)



*[Handwritten signature]*



PPENDIX REFERRED TO IN THE GENERAL CONDITIONS

- Defects liability period Six months.
- Date of commencement 3rd day from the date of issue of letter awarding the job.
- Stipulated period for completion. 21 days from the date of work order.
- Earnest Money Deposit (EMD). Rs.25000/-
- Initial security deposit till completion of work (ISD) 2% of the accepted contract value.
- Retention Money 8%, to be deducted from interim payments.
- Liquidated damages for non-completion of work within Stipulated period 1% of the contract value for every month of delay up to 6 months and 2% for every month, thereafter.



*Handwritten signature in blue ink.*



**TECHNICAL SPECIFICATIONS FOR FURNISHING WORKS**

1. While quoting rate for each item of work, the contractor shall also include for the following irrespective of whether it has been mentioned or not in the detailed specifications of the item. The contractor shall not be paid any extra cost.
  - All ply board/plywood/door shutters used shall be phenol bonded , exterior (BWP) grade conforming to latest relevant IS codes shall be used.
  - All unexposed surface of wood/ply board/plywood (any variety) used shall be treated with necessary coats of anti termite treatment.
  - All unexposed surfaces of wood/ply board/plywood (any variety) used shall be treated with synthetic enamel of approved make, unless otherwise specified.
  - All metal work shall be treated with anti corrosive treatment.
  - All exposed edges of wood (any variety) shall be finished with wood primer / putty and paint / melamine finish/distress stain polish etc.
  - All exposed edges of wood/ply board/plywood (any variety) used shall be finished with 6.0mm thick teakwood lipping unless otherwise specified.
  - All brass work, fittings & fixtures shall have lacquered finish.
2. The specifications which are not included in the technical specifications mentioned in the tender shall be as per ISI specifications/ Instruction of Employer/Architect.
3. Thickness used shall be as following unless otherwise specified-
  - Laminate used shall be 1.0mm thick
  - Teak or cedar veneer/ply used shall be 4.0mm thick
  - Water proof/waterproof ply shall be 9.0mm thick
  - Water proof/waterproof board shall be 19mm thick.
  - Pre polished marble/granite stone shall be 20mm. Tolerance of +/-2.0mm shall be allowed for thickness.
4. The basic rate of marble, granite and fabric has been indicated in detailed specifications of the respective items. Any difference between the specified basic rates and approved material purchased rate shall be adjusted on either side, accordingly.
5. The contractors are advised to refer the drawings for dimensions, sizes, etc., to cross check the BOQ and then quote accordingly.
6. Any substandard materials used during the execution shall be rejected. The contractor shall replace the same, to the entire satisfaction of the UBI, **Aryavart Bank, Regional Office, Bhinga Add-Hospital Chauraha, First Floor, Civil Line Bahraich, Pin-271801 (U.P.)**/Architect, at his own cost.
7. The contractor shall engage at least two technically sound, experienced, skillful competent and qualified graduate engineers at site one each for interior/civil works and electrical works. They shall take the instructions from the **Aryavart Bank, Regional Office, Bhinga Add-Hospital Chauraha, First Floor, Civil Line Bahraich, Pin-271801 (U.P.)**/Architect and supervise the work constantly. The work shall not suffer due to lack of supervision at site.
8. The contractor or his authorized representative shall remain at site and supervise the total project. The representative shall always bear a copy of authority of letter from the contractor and a copy of it shall be submitted to Regional Manager.  
The contractor shall also submit on undertaking to the Regional manager mentioning that he shall bear the total responsibility for any sort of injury or physical damage done to the sub structure and ground floor, nearby



*[Handwritten signature]*



structures, workmen employed at site, staff member of bank, public coming to bank, residents staying nearby, passer by etc.

Bank does not hold any responsibility for any sort of disputed or accident, which has arisen from the said job. All of them shall be on the contractor's account.

9. The contractor shall not be paid extra for making of any cut out/opening for electrical/air-conditioning wiring/fitting in any of the item of false ceiling, partitions, paneling, skirting, masonry work etc.
10. The contractor shall fabricate and submit, at site, one or more samples of each item as instructed by Aryavart Bank, Regional Office, Bhinga Add-Hospital Chauraha, First Floor, Civil Line Bahraich, Pin-271801 (U.P.)//Architect for approval. The bulk production of the each item shall be taken in hand only after the final approval of sample of each item. It shall be the entire responsibility of the contractor to get the sample approved by the Aryavart Bank, Regional Office, Bhinga Add-Hospital Chauraha, First Floor, Civil Line Bahraich, Pin-271801 (U.P.)//Architect spending the minimum time and no extension of time shall be granted for getting the late approval of the samples. The approved samples shall be kept at site in the custody of the Aryavart Bank, Regional Office, Bhinga Add-Hospital Chauraha, First Floor, Civil Line Bahraich, Pin-271801 (U.P.) // Architect. However, the same shall be taken back by the contractor after the completion of work in all respects.
11. The contractor, whenever asked shall submit basic unit rates of all constituent materials and labour required for completion of any particular item. These rates shall be for the analysis of any extra or substituted items.
12. Openings in partitions/paneling/ceiling etc. shall be deducted as per IS specifications and wherever the same is not available, the opening more than 0.11 Sq. Mt shall be deducted.



*Signature*



## DETAILED SPECIFICATIONS FOR FURNISHING WORKS

### A. FURNISHING WORKS

#### 1. Toughened Glass Partitions & Door

Providing and fixing in position toughened glass partitions, using 12.0 mm thick toughened float glass partition & door. The glass shall be in accordance to profile and pattern approved by the Architect. The erection of partition & door shall include for SS cleats, clamps, webs and other accessories, all complete up to the satisfaction of the Architect.

Each door shutter shall have SS patch fittings (for door closing and opening, lock & a pair of handles etc.). The rate shall include cost of all materials, labour, T&P, wastages, etc. required for proper completion of work, all complete to the satisfaction of the Architect.

Providing and fixing of 12 mm thick toughened frosted glass divider between machines with necessary fittings and hardware as per drawing. The rate shall include cost of all materials, labour, T&P, wastages, etc. required for proper completion of work, all complete to the satisfaction of the Architect.

#### 2. False Ceiling - Gypsum Board

Providing and fixing false ceiling of gypsum plaster board 12.5mm thick, of approved make, in required form / shape. It shall be installed with the use of perimeter channels (MF 6A) leveled at the required position above the finished ceiling line and fixed to the wall at 610mm centres. The remaining metal component shall be installed to form a regular grid, suspended from soffit cleats (fixed to the existing ceiling with help up expansion rawl plug W.E. type 12mm) and in turn by ceiling angle (MF-8) at 1220mm centres. The ceiling angles shall be connected to the intermediate channels (MF 7) which shall be set 1220mm apart. M / F ceiling section (MF 5) shall be fixed at 450mm centres at right angles to the underside of intermediate channels using connecting clips (MF 9).

The gypsum board shall be fixed with the bound edges at right angles to (MF 5) ceiling section with all joints staggered. Gypsum board shall be screwed to the M/F ceiling section and perimeter channels at board ends with gypsum board dry wall screws with joints staggered. Jointing and screws spotting shall be then, carried out accordingly at 200mm centres. Tapered edge board used, shall be then taped and filled to give a smooth, seamless ceiling which shall have all components/accessories to receive lighting fittings, access panels; A/C grills, diffusers, trap doors and similar component as part of the design requirements. It shall also include for two or more coats of plastic emulsion paint (as/shade approved by the Architect), of approved make, all complete.

The rate shall also include cost of all ancillary materials such as plaster of paris, primer, glue (Fevicol), stainer, brushes/roller, sand paper, patti, dhoti, broom stick, clean water with storage and other containers, labour, scaffolding / ladder charges, shifting of furniture items, cleaning of floors and other sundries etc. required for proper completion of work, all complete to the satisfaction of the Bank / Architect.

#### 3. False Ceiling - Mineral Fibre

Providing and fixing of false ceilings at all heights made out of Mineral Fibre Acoustical False Ceiling Tiles of size 600mm. x 600mm. x 15mm. (Make - ARMSTRONG OR EQUIVALENT, Type - Fine Fissured RH - 95% with Tegular edge). It shall be laid on Armstrong's prelude XL hot dipped galvanised exposed grid systems with 24mm. wide T-section exposed flanges which shall be powder coated in white colour. The frame work shall comprise of Main Runner made from 0.33 mm. thick GS sheet and of size 24mm.x38mm.x3600mm. and spaced at 1200mm. centres securely fixed to the structural soffit by approved hangers at 1200mm. maximum centres. Hangers shall be made out of GI wire of 4mm. dia. and shall be fixed by approved rawl plug, level adjusters and screws etc. The last hanger at the end of each main runner shall not be greater than 450mm. from the adjacent wall. Flush fitting of 1200mm. long Cross Tees (with double stitching) to be interlocked between Main Runners at 600mm. centres to form 1200x600mm. modules. Cut Cross Tees longer than 600mm. to be supported independently, 600mm.x 600mm. modules to be formed by fitting 600mm. long, flush fittings. Cross Tee centrally between the 1200mm. Cross Tees Perimeter Wall Angle shall be of 0.45 thick GS steel and of size 22mm. x 22mm. and 3000mm. long of White Colour shall be secured to walls at 450mm. maximum centres, all complete to the satisfaction of the Architect.

#### 4. Solid Partitions (partly glazed or fully unglazed) and Doors.

Providing and fixing of wooden partitions made out of 50mm x 40mm kail/partial wood (with anti- termite) under framing for horizontal (at 0mm, 75mm, 750mm, 900mm, 1500mm, 2100mm, 2550mm and ceiling levels) & vertical (at 600mm c/c approx.) divisions or as per site conditions. It shall be covered with 6mm thick water proof ply with 1mm thick laminate, (from 0mm to 750mm and 2100mm to 2550 mm/ceiling levels) on both sides. The design shall have 6mm x 4mm grooves (horizontal or vertical) at various levels, as suggested by the Architect.

The job shall also include for provision of laying conduits, switch boxes etc. The erection of partition shall include for expansion bolts cleats, clamps bolts, nuts, screws, rivets and other accessories, all complete up to the satisfaction of the Architect.

All door opening shall have rebated leak wood framework (size - 75mm x 50mm, as per profile) on vertical (2 Nos.) and horizontal (1 No.) sides, with melamine finish and rebate of 40mm x 12mm, all complete up to the satisfaction of the Architect.

It shall also include for door shutters, as per required width and 2100mm high. It shall be made out of 75mm x 25mm kail/partial wood (with anti-termite) under framing for styles, top, middle and 100mm x 25mm for bottom rail. It shall be covered with 6mm thick water proof ply with 1mm thick laminate, (from 0mm to 900mm and other under frames) in shade and pattern approved by the Architect, on both sides. The design shall have 6mm x 4mm grooves (horizontal or vertical) at various levels, as suggested by the Architect. Door shutters shall have leak wood edging (size - 40mm x 10mm, as per profile) on all sides, with melamine finish. Each shutter shall have hinges, floor springs/sliding arrangement/hydraulic door closer (heavy duty), mortise locks, etc. The rate shall include cost of all materials, labour, T&P, wastages, etc. required for proper completion of work, all complete to the satisfaction of the Architect.





5. **Wooden Partitions (partly glazed or fully unglazed) and Doors.**  
 Providing and fixing of wooden partitions made out of 50mm x 40mm kail/partial wood (with anti- termite) under framing for horizontal (at 0mm, 75mm, 750mm, 900mm, 1500mm, 2100mm, 2550mm and ceiling levels) & vertical (at 600mm c/c approx. divisions or as per site conditions. It shall be covered with 6mm thick water proof ply with 1mm thick laminate, (from 0mm to 750mm and 2100mm to 2550 mm/ceiling levels) on both sides. The design shall have 6mm x 4mm grooves (horizontal or vertical) at various levels, as suggested by the Architect.
- It shall have 8mm thick float glass (from 900mm to 2100mm) fixed with teak wood beading (size - 30mm x 20mm, as per profile) with melamine finish. The job shall also include for provision of laying conduits, switch boxes etc. The erection of partition shall include for expansion bolts cleats, clamps bolts, nuts, screws, rivets and other accessories, all complete up to the satisfaction of the Architect.
- All door opening shall have rebated teak wood framework (size - 75mm x 50mm, as per profile) on vertical (2 Nos.) and horizontal (1 No.) sides, with melamine finish and rebate of 40mm x 12mm, all complete up to the satisfaction of the Architect.
- It shall also include for door shutters, as per required width and 2100mm high. It shall be made out of 75mm x 25mm kail/partial wood (with anti-termite) under framing for styles, top, middle and 100mm x 25mm for bottom rail. It shall be covered with 6mm thick water proof ply with 1mm thick laminate, (from 0mm to 900mm and other under frames) in shade and pattern approved by the Architect, on both sides. The design shall have 6mm x 4mm grooves (horizontal or vertical) at various levels, as suggested by the Architect, on both sides. The design shall have 6mm x 4mm grooves (horizontal or vertical) at various levels, as suggested by the Architect, on both sides also have 8mm thick float glass (from 900mm to 2025mm) fixed with teak wood beading (size - 20mm x 20mm, as per profile) with melamine finish. Door shutters shall have teak wood edging (size - 40mm x 10mm, as per profile) on all sides, with melamine finish. Each shutter shall have hinges, floor springs/sliding arrangement/hydraulic door closer (heavy duty), mortise locks, etc. The rate shall include cost of all materials, labour, T&P, wastages, etc. required for proper completion of work, all complete to the satisfaction of the Architect.
6. **Low Height Wooden Partitions (partly glazed) and Flap Doors.**  
 Providing and fixing of low height wooden partitions made out of 50mm x 40mm kail/partial wood (with anti-termite) under framing for horizontal (at 0mm, 75mm, 750mm, 900mm, 1500mm, levels) & vertical (at 600mm c/c approx.) divisions or as per site conditions. It shall be covered with 6mm thick water proof ply with 1mm thick laminate, (from 0mm to 1500mm) on both sides. The design shall have 6mm x 4mm grooves (horizontal or vertical) at various levels, as suggested by the Architect. It shall also have teak wood edging (size - 75mm x 25mm, as per profile) on all exposed edges with melamine finish. It shall have 8mm thick float glass (from 900mm to 1500mm) fixed with teakwood beading (size - 30mm x 20mm, as per profile) with melamine finish. The job shall also include for provision of laying conduits, switch boxes etc. The erection of partition shall include for expansion bolts cleats, clamps bolts, nuts, screws, rivets and other accessories, all complete up to the satisfaction of the Architect.
- All flap door opening shall have rebated teak wood framework (size - 75mm x 25mm, as per profile) on vertical (2 Nos.) sides, with melamine finish and rebate of 40mm x 12mm, all complete up to the satisfaction of the Architect.
- It shall also include for flap door shutters, as per required width and 1500mm high. It shall be made out of 75mm x 25mm kail/partial wood (with anti- termite) under framing for styles, top, middle and 100mm x 25mm for bottom rail. It shall be covered with 6mm thick water proof ply with 1mm thick laminate, (from 0mm to 1500mm) in shade and pattern approved by the Architect, on both sides. The design shall have 6mm x 4mm grooves (horizontal or vertical) at various levels, as suggested by the Architect. Flap door shutters shall have teak wood edging (size - 40mm x 10mm, as per profile) on all sides, with melamine finish. Each shutter shall have hinges, floor springs/sliding arrangement/hydraulic door closer (heavy duty), mortise locks, etc. The rate shall include cost of all materials, labour, T&P, wastages, etc. required for proper completion of work, all complete to the satisfaction of the Architect.
7. **Glass Barrier.**  
 Providing and fixing glass barrier (as per profile and design) in front of cash and ledger counter made out of 12mm thick polished edged float glass (Make – Modi guard or equivalent). It shall have 25mm x 20mm teakwood beading (as/shape approved by the Architect) to hold the glass from sides and top (optional). All teak wood surfaces shall be melamine polished. The rates shall include for cutting (in geometrical shape) and polishing the edges, all complete to the satisfaction of the Architect.
8. **Mortise Locks (with handle set).**  
 Providing and fixing of mortise locks with handle set (Make – Godrej, Product Code - 5412 / 5414 or equivalent). It shall incorporate the following –
- 6 – brass lever.
  - Suitable for right handed or left handed, inside or outside opening doors.
  - The keyless latch shall be opened from either side of the door by turning the handle.
  - It shall work as latch which locks from inside at the turn of a button and as a lock operable with a key from outside.
- All complete to the satisfaction of the Architect.
9. **Hydraulic Door Closure.**  
 Providing and fixing of hydraulic door closure (Make - Godrej, Product Code - 4539 or equivalent) for doors. It shall incorporate the following –
- Body manufactured from Aluminium extruded alloy machined to extreme accuracy.
  - Rack and Pinion-made of machined alloy steel duly heat - treated.
  - Adjustable closing speed.
  - Suitable for right hand and left hand opening doors.
  - Suitable for door/frame mounting.
  - Suitable for door weight up to 60 kgs.
  - Suitable for 180 / 100 degree door opening.
- All complete to the satisfaction of the Architect.





10. **Oil Bound Distemper.**  
Distemping on undecorated / decorated wall and ceiling surfaces with two or more coats, to give an even shade, of oil bound distemper (as / shade approved by the Architect) of approved brand. It shall include for preparing the surfaces clean, even and smooth with thoroughly brushing with broom, scratching with patti and sand papering respectively, so that the surfaces are free from oil, grease, dirt, mortar droppings & other foreign and loose matter. It shall also include for preparing the surface and filling of holes with plaster of paris before priming coat of whitening / approved primer.  
The rate shall include cost of all materials such as sealed containers of oil bound distemper, plaster of paris, whitening / primer, glue (Fevicol), stainer, brushes, sand paper, patti, dhoti, broom stick, clean water with storage and other containers, labour, scaffolding / ladder charges, cleaning of floors, shifting of furniture and other sundries etc., all complete to the satisfaction of the Architect.
11. **Acrylic Emulsion with POP Base.**  
Painting on undecorated / decorated wall and ceiling surfaces with two or more coats of acrylic emulsion (as / shade approved by the Architect) of approved brand. It shall include for preparing the surfaces clean, even and smooth with thoroughly brushing with broom, scratching with patti and sand papering respectively, so that the surfaces are free from oil, grease, dirt, mortar droppings & other foreign and loose matter. It shall also include for preparing the surface and filling of holes with plaster of paris before priming coat of whitening / approved primer.  
The rate shall include cost of all materials such as plaster of paris, whitening / primer, glue (Fevicol), indigo / stainer, brushes, sand paper, patti, dhoti, broom stick, clean water with storage and other containers, labour, scaffolding / ladder charges, cleaning of floors and other sundries etc., all complete to the satisfaction of the Architect.
12. **Synthetic Enamel.**  
Painting on new / old surfaces with two or more coats, to give an even shade, of synthetic enamel (as / shade approved by the Architect) of approved brand. It shall include for preparing the surfaces clean, even and smooth with thoroughly brushing with broom, scratching with patti and sand papering respectively, so that the surfaces are free from oil, grease, dirt, mortar droppings & other foreign and loose matter. It shall also include for filling of holes, knotting and stopping before priming coat of approved primer.  
The rate shall include cost of all materials such as sealed containers of synthetic enamel, plaster of paris, whitening / primer, glue (Fevicol), stainer, brushes, sand paper, patti, dhoti, broom stick, clean water with storage and other containers, labour, scaffolding / ladder charges, cleaning of floors, shifting of furniture and other sundries etc., all complete to the satisfaction of the Architect.
13. **Wall Panelling**  
Providing and fixing of wall panelling made out of 50mm x 40mm kail/partial wood (with anti-termite) under framing for horizontal (at 0mm, 75mm, 150mm, 210mm and 2550mm levels) & vertical (at 600mm c/c approx.) divisions or as per site conditions. It shall be covered with 6mm thick water proof ply with 1mm thick laminate in shade and pattern approved by the Architect. The design shall have 6mm x 4mm grooves (horizontal or vertical) at various levels, as suggested by the Architect.  
The low height wall panelling shall also have teak wood edging (size - 75mm x 25mm, as per profile) on top edge with melamine finish.  
The erection of partitions shall include for expansion bolts, cleats, clamps, bolts, nuts, screws, rivets and other anodized accessories. The job shall also include for provision of laying conduits, switch boxes etc., all complete up to the satisfaction of the Architect.
14. **Pin-up Board.**  
Providing and fixing in position pin-up board (as per design). It shall have 12mm thick soft board (Make - Cellox or equivalent) laminated with carpet cloth (Make - Unilex, Type - Uisav) as/shade approved by the Architect. It shall have backing with 12mm thick marine plywood. The fixing shall include for expansion bolts, cleats, clamps, bolts, nuts, screws, rivets and other anodized accessories, all complete up to the satisfaction of the Architect.
15. **Tables.**  
Providing and placing in position tables with top, vertical sides/dividers, skirting and modesty panel made out of 19mm thick water proof board with 1mm thick laminate (as/shade approved by the Architect) on all exposed surfaces. It shall also have 75mm x 40mm leak wood runners below the top and for footrest below.  
Every table shall be provided with a side unit (size - W-500mm, H-750mm, D-500mm approx.), consisting of 150 mm deep drawer at top and a cabinet with open abel/hinged shutter below. The fascia of drawer and shutter of cabinet below shall be made out 19mm thick water proof board with 1mm thick laminate (as/shade approved by the Architect) and sides and bottom of drawer shall be made out of 12mm thick water proof ply. The side unit shall have CAM locks, handles, guides, sliding units, hinges, magnetic catcher's etc. of approved make.  
Every table shall be provided with a keyboard drawer unit (size - W-550mm, H-100mm, D-300mm approx.) below. The table shall have 100mm deep fascia, below the top, in which keyboard drawer unit shall be adjusted. It shall be made out 19mm thick water proof board with 1mm thick laminate (as/shade approved by the Architect) and sides and bottom of drawer shall be made out of 12mm thick water proof ply. The unit shall have CAM locks, handles, guides, sliding units etc. of approved make.  
The job shall include for 6mm x 6mm grooves in between sides and open able drawers and hinged shutters. All the exposed edges of water proof board and ply shall be provided with 6mm thick leak wood/hard wood liping. All leak wood surfaces shall be melamine polished and other internal surfaces shall be painted with two coats of synthetic enamel over one coat of primer, all complete to the satisfaction of the Architect.  
Every table top shall be provided with 12mm thick float glass (as per profile) with polished and beveled (25mm wide) edges, all complete to the satisfaction of the Architect.



*[Handwritten signature]*



	(L)		(W)		(H)
Officer Table with glass top	1800 mm	x	750 mm	x	750 mm (as/profile)
Printer Table with glass top	1500 mm	x	750 mm	x	750 mm (as/profile)

16. **Credenza.**

Providing and placing in position credenza of size - 1050mm x 500mm x 680mm The top, vertical sides/dividers, skirting, bottom and intermediate shelves shall be made out of 19mm thick water proof board with 1mm thick laminate (As/shade approved by the Architect) on all exposed surfaces. It shall also have 6mm thick water proof ply on the back.

Every credenza shall have a unit (size - W-450mm, H-675mm, D-500mm approx.) consisting of 150mm deep drawer at top and a cabinet with open able/hinged shutter below. The balance frontage shall have a cabinet with hinged shutter and intermediate shelf (1 No.) made out of 19mm thick water proof board with 1mm thick laminate (as/shade approved by the Architect), on all exposed surfaces. The sides and bottom of drawer shall be made out of 12mm thick water proof ply. The credenza shall have CAM locks, handles, guides, sliding units, hinges, magnetic catchers etc. of approved make.

The job shall include for 6mm x 6mm grooves in between sides and open able drawers and shutters. All the exposed edges of water proof board and ply shall be provided with 6mm thick teak wood/hard wood lipping. All teak wood surfaces shall be melamine polished and other internal surfaces shall be painted with two coats of synthetic enamel over one coat of primer, all complete to the satisfaction of the Architect.

17. **Vertical Blinds.**

Providing, fixing and testing of vertical blinds (Make – Vista levolor or equivalent) made out of 100mm wide, scotch guarded, fabric louvers (as / shade & pattern approved by the Architect). It shall also include for Head rail, Control unit, Carriers, Tilter, Traverse cord, Tilt rod, Bottom mechanism, Installation bracket etc., all complete to the satisfaction of the Bank / Architect.

18. **Storage Cabinet.**

Providing and fixing in position (floor mounted) storage cabinets with drawers and hinged shutters having vertical dividers (at 450mm to 600 mm approx.) and horizontal shelves at different levels. It shall be made out of 19mm thick water proof board with 1mm thick laminate (as/shade approved by the Architect) on all exposed surfaces. It shall also have 6mm thick waterproof plywood on the back. Every cabinet shall consist of 150mm deep drawer at top and open able/hinged shutter below. The fascia of drawer and shutter of cabinet below shall be made out 19mm thick water proof board with 1mm thick laminate (as/shade approved by the Architect) and sides and bottom of drawer shall be made out of 12mm thick waterproof ply. The drawer as well as shutters shall have CAM locks, handles, guides, sliding units, hinges, magnetic catcher's etc. of approved make.

It shall also include for providing and fixing in position (wall mounted) storage cabinets with hinged shutters having vertical dividers (at 450mm to 600 mm approx.) and horizontal shelves at different levels. It shall be made out of 19mm thick waterproof board with 1mm thick laminate (as/shade approved by the Architect) on all exposed surfaces. It shall also have 6mm thick waterproof plywood on the back. The shutters shall have CAM locks, handles, guides, sliding units, hinges, magnetic catcher's etc. of approved make.

The erection of storage cabinets shall include for expansion bolts, cleats, clamps, bolts, nuts, screws, rivets and other anodized accessories, all complete up to the satisfaction of the Architect.

19. **Rolling Shutter Box.**

Providing and fixing of Rolling Shutter Box made out of 50mm x 50mm teak wood (with anti-termite) under framing with horizontal & vertical (at 600mm c/c approx.) divisions or as per site conditions. It shall be covered with 12mm thick water proof plywood on all sides with 1mm thick laminate in shade and pattern approved by the Architect.

The erection of Rolling Shutter Box shall include for expansion bolts cleats, clamps bolts, nuts, screws, rivets and other accessories. The job shall also include for provision of laying conduits, switch boxes etc., all complete up to the satisfaction of the Architect.

It shall include for painting on new surfaces of water proof plywood with two or more coats of synthetic enamel (as / shade approved by the Architect) of approved brand. It shall include for preparing the surfaces clean, even and smooth with thoroughly brushing with broom, scratching with patti and sand papering respectively, so that the surfaces are free from oil, grease, dirt, mortar droppings & other foreign and loose matter. It shall also include for filling of holes, knotting and stopping before priming coat of approved primer. The rate shall include cost of all materials, labour, scaffolding, T&P, wastages etc. required for proper completion of work, all complete to the satisfaction of the Architect.

20. **Dismantling of Existing Items & Transporting Debris.**

Removing (with out damaging the building) carefully existing items (as approved by Architect) as in accordance to lay out and carting away the debris at a distance beyond 60 meters (200 feet) as directed by the municipal / statutory authorities.

The rate shall include cost of labour, temporary timbering (shuttering), scaffolding / ladder, shifting of furniture items, lifting up and down, mechanical transportation, loading, unloading, any or special T&P (pneumatic hammers, rcc / mild steel cutting machines etc.), periodic / regular cleaning of ground floors (inside and outside) and other sundries etc. required for proper completion of work, all complete to the satisfaction of the Bank / architect.



*[Handwritten signature]*



**LIST OF APPROVED MAKE OF MATERIALS**

Wood	Kail wood, Champwood
Synthetic Enamel/ Spirit Polish	Asian/ Shalimar / ICI / Nerolac / Berger/Dulux
Plywood/Block Board/Laminate	Green/ Archid / Alpro/ Duro/ Marino
Hardware/ Hinges/ Channels/ Floor Springs/ Locks	Ecco/Hettich/Ozone/Harrison/Godrej/ Eboo
Glue	Fevicol/ Vernicol
Glass	Modi Guard, Saint Gobain
Flush Door	Green/Archid/ Alpro/Duro/Marino
Gypsum Board False Ceiling	India Gypsum, Gyproc
Mineral Fibre False Ceiling	Armstrong
Cement	ACC/ Ambuja/ Ultratech/ JK/ Birla L&T

Authorized Signatory

Signature Name

Designation

Seal of Company

Date & Place



*[Handwritten signature]*



QUOTATION FOR FURNISHING WORKS AT ARYAVART BANK Regional office Bhinga

S.NO.	DESCRIPTION OF ITEM	QUANTITY	UNIT	RATE (Rs.)	AMOUNT (Rs.)
<b>A. FURNISHING WORKS.</b>					
1	Toughened Glass Partition & Door	165	Sq.Ft		
2	False Ceiling Gypsum Board	0	Sq.Ft		
3	False Ceiling Grid	0	Sq.Ft		
4	Wooden Partitions (Solid /unglazed) and Doors	208	Sq.Ft		
5	Wooden Partitions (partly glazed or fully unglazed) and Doors	1124	Sq.Ft		
6	Wooden Partitions Low Height (partly glazed) and Flap Doors	1365	Sq.Ft		
7	Wooden Partitions Low Height (Solid) and Flap Doors	400	Sq.Ft		
8	Glass Divider	44	Nos.		
9	Mortice Locks (with handle set)	5	Nos.		
10	Hydraulic Door Closure	5	Nos.		
11	Oil Bound Distemper	0	Sq.Ft		
12	Acrylic Emulsion With POP Base	0	Sq.Ft		
13	Synthetic Enamel	0	Sq.Ft		
14	Wall Panelling	875	Sq.Ft		
15	Pin-up Board	40	Sq.Ft		
16	Tables				
	a. Manager Table With Glass Top	8	Nos.		
	b. Officer Table	34	Nos.		
	c. Printer Table	2	Nos.		
17	Credenza	8	Nos.		
18	Vertical Blinds	165	Sq.Ft		
19	Storage Cabinet	1200	Sq.Ft.		
20	Rolling Shutter Box	115	Sq.Ft		
21	Excutive Table	1	No.		
22	Confrence Table	55	Rt		
23	Sofa 3 Seater	2	Nos.		
24	Central Table	2	Nos.		
25	Main Electrical Box	32	Sq.Ft		
<b>TOTAL OF FURNISHING WORKS (Rs.)</b>					



*[Handwritten signature]*







41'-10"

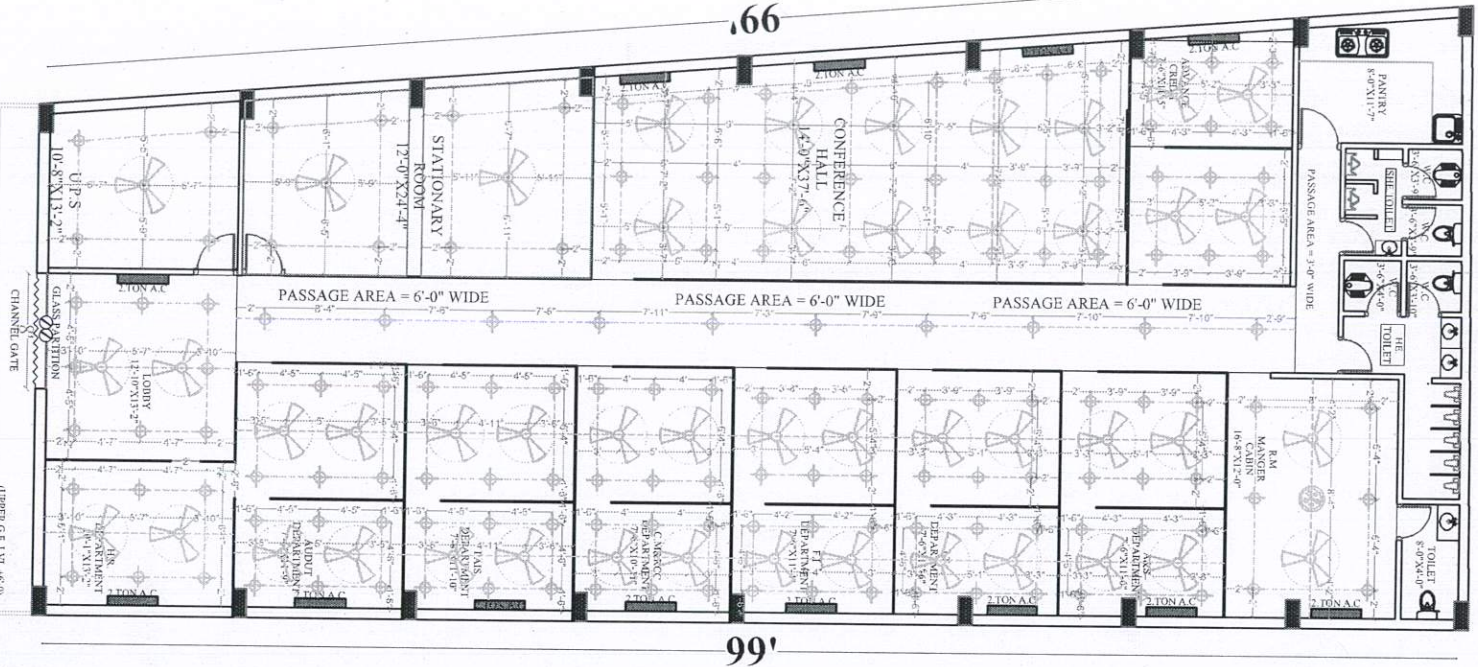

ARYA VARTI BANK  
REGIONAL OFFICE BHINGNA

ELECTRICAL PLAN



LEGEND	
	FAN POINT @ CEILING
	GYSER +7-0" HEIGHT
	16 AMP. A.C. POINT @1'-6" HIGH
	15AMP. POINT @ 4'-0" IN KIT., 6'-0" IN TOI.
	5AMP. POINT @4'-0" IN KIT/ TOILET
	SWITCH BOARD @ 4'-0" HIGH
	SHOW LAMP @9-0" HIGH
	BRACKET LIGHT POINT @ 9'-0" HIGH
	CEILING LIGHT POINT
	TELEVISION POINT @4'-0" HIGH
	FOOT LIGHT @1'-0" HIGH
	TUBE LIGHT @ 9'-0" HIGH
	M.C.B. @ 6'-0" HIGH
	GATE LIGHT
	METER BOX @ 6'-0" HIGH
	CALL BELL@ 5'-0" HIGH
	BUZZER @ 9'-0" HIGH
	MIRROR LIGHT @6'-0" HIGH
	EXHAUST FAN
	CHANDELLIER

Digitally signed by VIVEK SINGH

Date: 2024.05.22

18:58:28

+05'30'





## आर्यावर्त बैंक

क्षेत्रीय कार्यालय-भिनगा

टैकनीकल विड हेतु आवेदन पत्र

इंटीरियर फनिशिंग कार्य हेतु आवेदन करने वाली फर्म से संबंधित आवश्यक वांछित सूचनाएं

- 1- इंटीरियर फनिशिंग कार्य के क्षेत्र में फर्म का अनुभव .....वर्ष
- 2- क्या फर्म द्वारा निम्न संस्थाओं हेतु इंटीरियर फनिशिंग कार्य किया गया है।
  - अ. पब्लिक सेक्टर / राष्ट्रियकृत बैंक - हों / नहीं
  - ब. शीजनल रुरल बैंक (उ0प्र0) - हों / नहीं
- 3- क्या उक्त संस्थाओं द्वारा उनके लिए किये गये कार्य के संबंध में कोई विपरीत टिप्पणी अंकित की गई है- हों / नहीं  
(यदि हों तो उसका पूर्ण विवरण).....

4- विगत तीन वित्तीय वर्षों हेतु फर्म का औसत आय-व्यय (टर्न ओवर)

अ-वित्तीय वर्ष 2021-22 हेतु फर्म का औसत टर्न ओवर रू0.....लाख

ब- वित्तीय वर्ष 2022-23 हेतु फर्म का औसत टर्न ओवर रू0.....लाख

स- वित्तीय वर्ष 2023-24 हेतु फर्म का औसत टर्न ओवर रू0.....लाख

5- विगत तीन वित्तीय वर्षों में फर्म द्वारा सफलतापूर्वक पूर्ण की गई परियोजनाओं का विवरण :-

क्रमांक	वित्तीय वर्ष	परियोजना का विवरण	परियोजना लागत (साथे लाख में)
1			
2			
3			
4			
5			
6			
7			
8			
9			
10			

हस्ताक्षर-निविदाकर्ता

फर्म की मोहर-

दिनांक :-



*(Handwritten signature)*